

**HV angle valve,
DN 40 ISO-KF, manually
operated, 304/FKM, "A"-
dim. 65 mm**

PFEIFFER 

HV angle valve

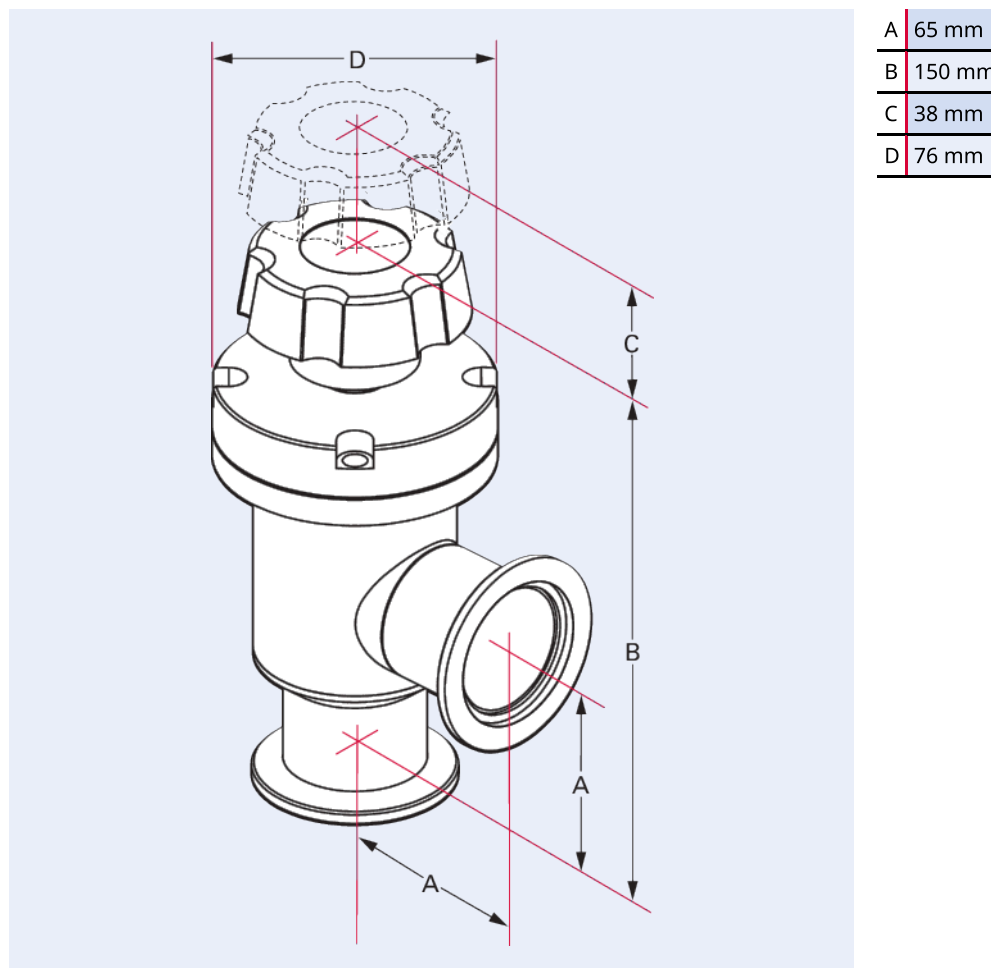

Illustration only

HV angle valve, DN 40 ISO-KF, manually operated, 304/FKM, "A"-dim. 65 mm

- With elastomer seals for high vacuum operation
- Stainless steel body with welded diaphragm bellows
- Conductance continuously variable with handwheel (multi-turn)
- Fully retracting and opening
- Additional O-ring materials available

Dimensions



Technical Data	HV angle valve, DN 40 ISO-KF, manually operated, 304/FKM, "A"-dim. 65 mm
Feedthrough	Bellows Stainless steel
Seal	FKM
Type	HV Angle valve
Housing	Stainless steel
Actuator	Spindle
Tightness	$1 \cdot 10^{-10}$ Pa m ³ /s $7.5 \cdot 10^{-10}$ Torr l/s $1 \cdot 10^{-9}$ mbar l/s
Bakeout temperature: actuator	60 °C 140 °F 333.15 K
Conductance value with molecular flow	37 l/s
Operating pressure min.	$1 \cdot 10^{-8}$ hPa $7.5 \cdot 10^{-9}$ Torr $1 \cdot 10^{-8}$ mbar
Pressure max. (absolute)	1,000 hPa 750 Torr 1,000 mbar
Bakeout temperature: housing	150 °C 302 °F 423.2 K
Differential pressure in closing direction	1,400 hPa 1,050 Torr 1,400 mbar
Differential pressure in opening direction	1,400 hPa 1,050 Torr 1,400 mbar
Weight	1.2 kg 2.65 lb
Connection flange	DN 40 ISO-KF

Order number	HV angle valve, DN 40 ISO-KF, manually operated, 304/FKM, "A"-dim. 65 mm
HV angle valve, DN 40 ISO-KF, manually operated, 304/FKM, "A"-dim. 65 mm	ESV-S04100

Accessories	HV angle valve, DN 40 ISO-KF, manually operated, 304/FKM, "A"-dim. 65 mm
Set of seals for valve ESVP/AIVP, DN 40	ESVP-150-95
Bellows kit for valve ESV/ESVP/AIV/AIVP, DN 40	ESV-150-16K



Are you looking for an optimum vacuum solution?

Talk to us:

Pfeiffer Vacuum GmbH

Germany

T +49 6441 802-0

Or scan the barcode, to visit our web page:



<https://webportal.pfeiffer-vacuum.com/global/en/contact>

Follow Us On Social Media

#pfeiffervacuum



www.pfeiffer-vacuum.com

PFEIFFER 